

**401**  
COD.

✓ **DIN 975-976**

**BF**

**BARRE FILETTATE**  
*THREADED RODS*  
*GEWINDESTANGEN*  
*TIGES FILETEES*

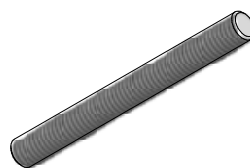
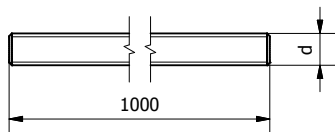

**Dimensions in mm**

d Filetto/Thread	M4	M5	M6	M8	M10	M12	M14	M16	M18	M20
Passo/Pitch Standard	-	M5x0.8	M6x1	M8x1.25	M10x1.5	M12x1.75	M14x2	M16x2	M18x2.5	M20x2.5

NOTE: Il prodotto in questione è disponibile solamente in lunghezza di un metro (cod. 000) o multipli di esso  
*The product is only available in lengths of one meter (cod. 000) or multiples of it*

**CODE EXAMPLE:**

**401** + material + thread + pitch + length

BF M6x1000 Al7075 = 4011060000

BF M8x1000 Ti GR5 = 4015080000

**46**

